



# Quick Start Guide



EOLife Connect is available on iOS and Android.  
Stay tuned to be informed about application updates

# HOME SCREEN

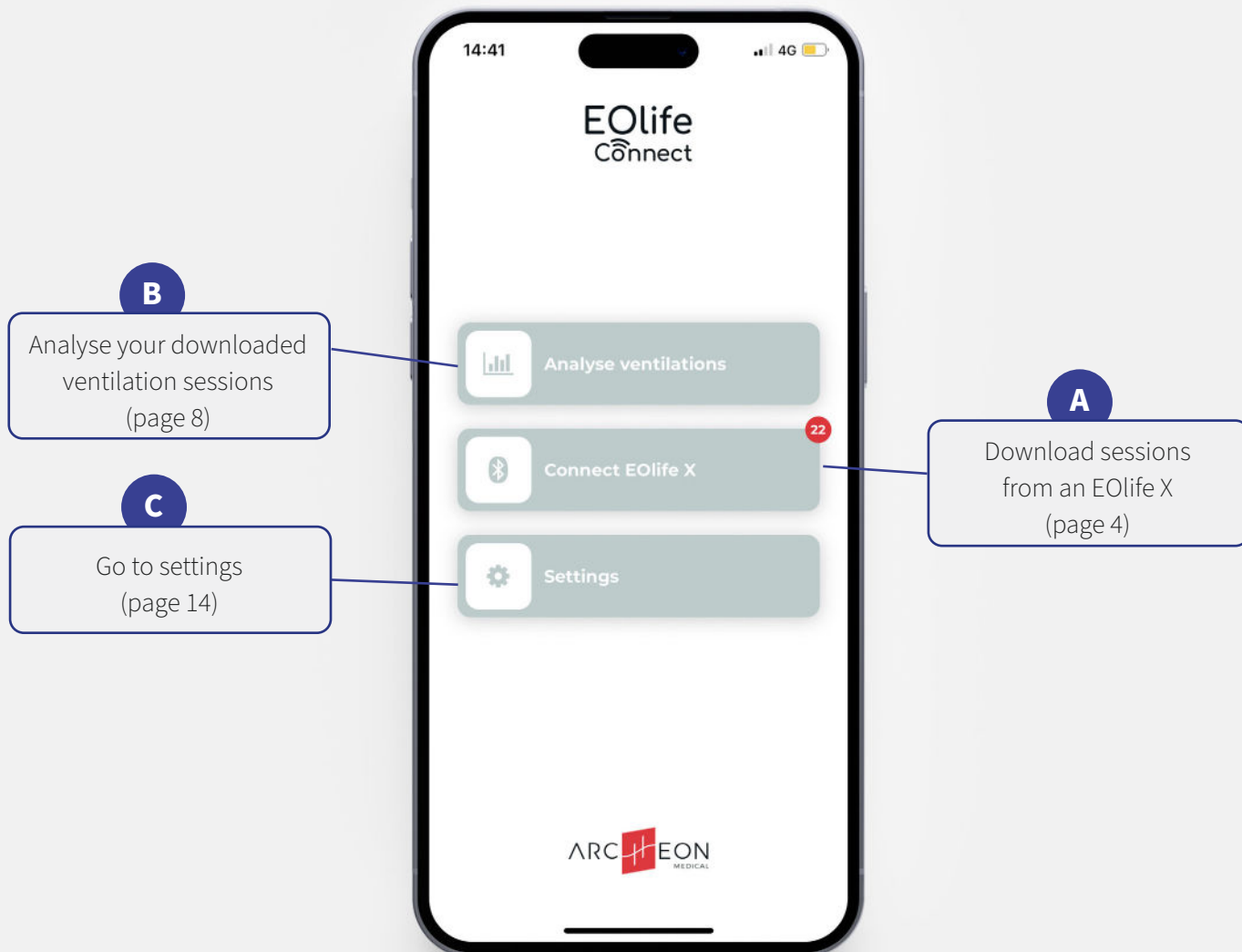

## A

# 01. DOWNLOAD SESSIONS

1

Select your EOLife X.

If your device doesn't appear in the list, press on re-scan

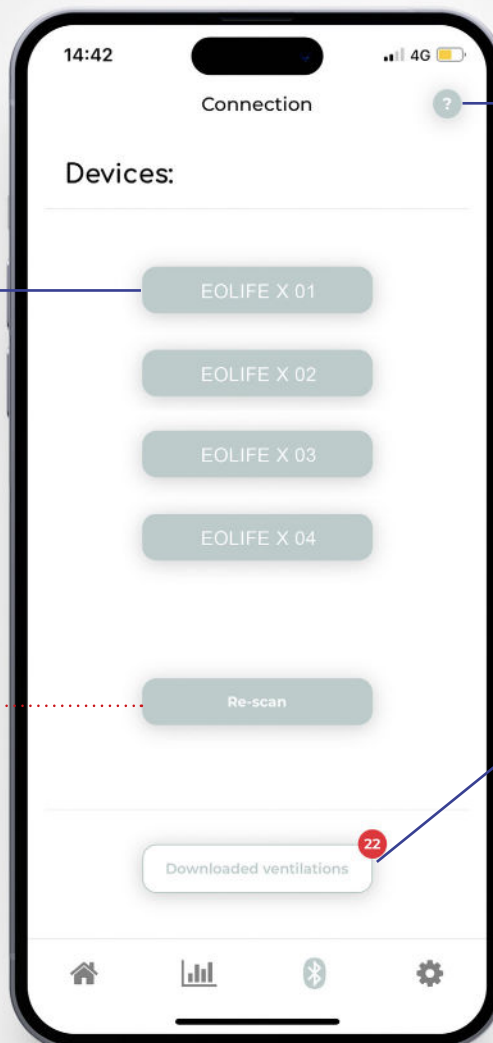

Download procedure  
(page 5)

2

Download all ventilation  
sessions from your EOLife X

**BE CAREFUL !**

Once imported in EOLife Connect, all your sessions will be deleted from your EOLife X.

# 02.DOWNLOAD PROCEDURE

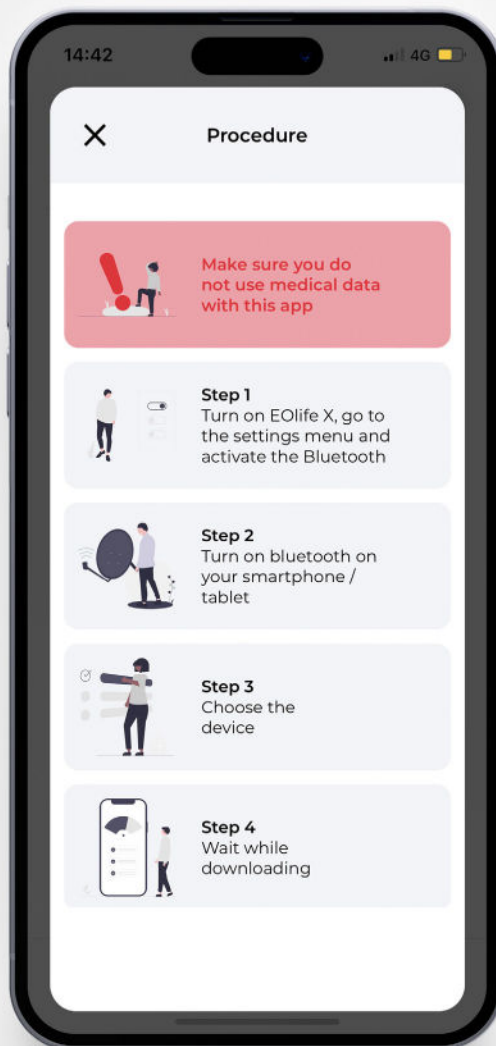
**A**

A

# 03.DOWNLOADED SESSIONS

1

Select a session. You can select multiple sessions by a long press on the screen.

Filter your list

2

Assign the session(s) to a user (page 7)

Deactivate the multiple selection

Delete all sessions (selected and unselected)

Delete the session (only with unique selection)

The screenshot shows the 'Downloaded ventilations' screen of an app. At the top, there's a status bar with the time 14:44, 4G signal, and battery level. Below the title bar, there are filter buttons for 'Serial number', 'Date', 'Duration', and 'Score'. A list of sessions follows, each with a red circle icon for selection. The sessions are: EOLife X0... 28/06/23 03:56 pm 00:00:05 50%, EOLife X0... 28/06/23 03:56 pm 00:04:10 3%, EOLife X0... 28/06/23 03:53 pm 00:01:44 0%, and EOLife X0... 28/06/23 03:47 pm 00:02:32 0%. A red 'Delete all' button is at the bottom right. A second screenshot below shows a detailed view of a session with a red 'X' icon for deletion.

SN	Date	Time	Duration	Score
EOLife X0...	28/06/23	03:56 pm	00:00:05	50%
EOLife X0...	28/06/23	03:56 pm	00:04:10	3%
EOLife X0...	28/06/23	03:53 pm	00:01:44	0%
EOLife X0...	28/06/23	03:47 pm	00:02:32	0%

Session ID	Date	Time	Duration	Score	Action
EOLife X0001...28/06/23	28/06/23	02:25 pm	00:05:54	0%	Delete
EOLife X0001...28/06/23	28/06/23	02:19 pm	00:00:17	50%	Delete
EOLife X0001...28/06/23	28/06/23	02:16 pm	00:00:12	100%	Delete
EOLife X0001...28/06/23	28/06/23	02:15 pm	00:00:25	0%	Delete
EOLife X0001...28/06/23	28/06/23	02:12 pm	00:00:35	71%	Delete
EOLife X0001...28/06/23	28/06/23	02:10 pm	00:00:49	21%	Delete

# 04.ASSIGN A USER

**A**

Select an existing user

Or create a new user

14:44

Assign a user

Create a new user

Select an existing user

Home Bar: Home, Chart, Bluetooth, Settings

14:45

Create a new user

Firstname \*

Firstname

Lastname \*

Lastname

Age

Age

Gender

Gender

Profession

Profession

Organisation

Organisation

Years of experience

Years of experience

Save

Home Bar: Home, Chart, Bluetooth, Settings

B

# 01.ASSIGNED SESSIONS

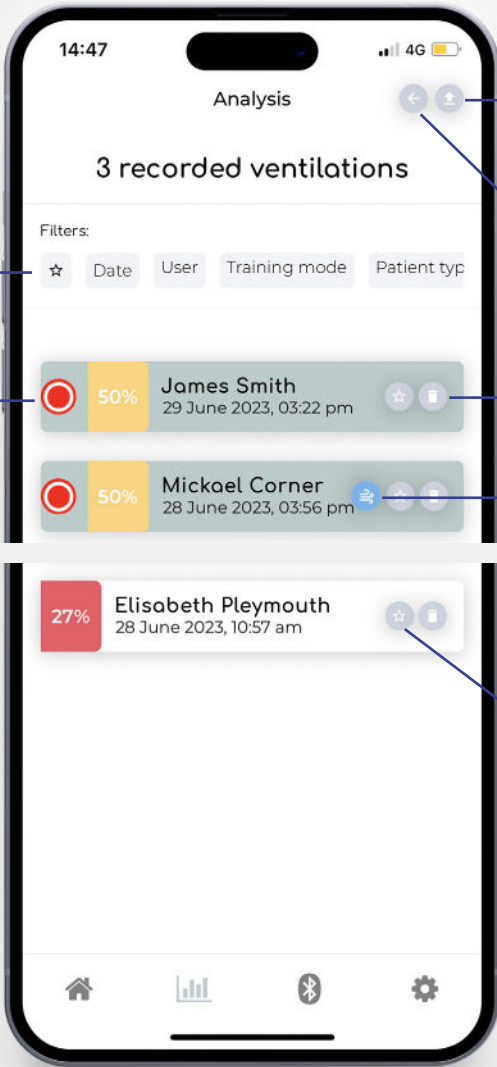

Filter your list

Select a session  
to see more details.  
(page 9)

You can select multiple  
sessions by a long press on  
the screen.

Download the CSV file(s) of  
the selected session(s)

Deactivate the  
multiple selection

Delete the session

The  icon indicates that  
the ventilation session was  
performed with «leakage  
alarm OFF». Therefore only Vi  
will be displayed.

Add the session  
to your Favorites



# 02.SSESSION DETAILS

B

Parameters of the session

Ventilation quality breakdown (page 11)

Ventilation Frequencies (page 12)

Volume details (page 13)

Duration of the session

Press to see more details

James Smith

Type  
Child  
Frequency  
ERC

Age  
1-2y

Mode  
Continuous

Training  
Monitored

 SCORE 50%

 MEAN FREQUENCY 20/min

 MEAN VT 55 mL

 DURATION 00:00:05

NUMBER OF RECORDINGS  
2







Download the CSV file of the session

Assign to another user

See student's progression (page 10)

B

# 03.STUDENT PROGRESSION

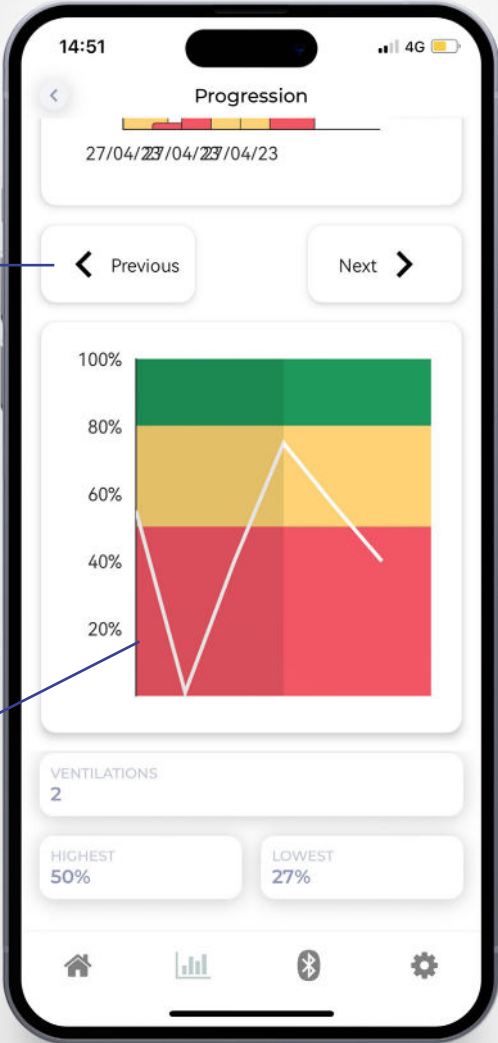
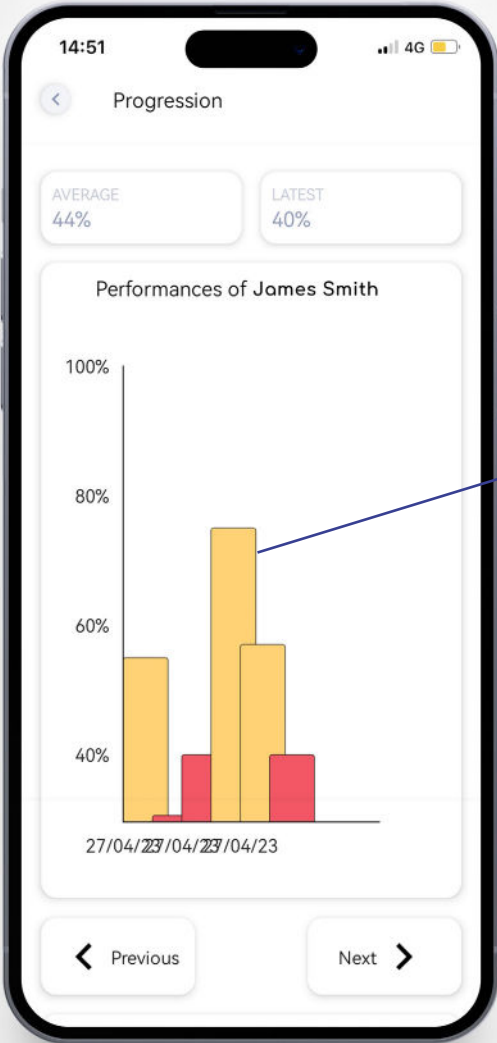

# 04. VENTILATION QUALITY BREAKDOWN

B

Press to see the percentage of each triggered alarms

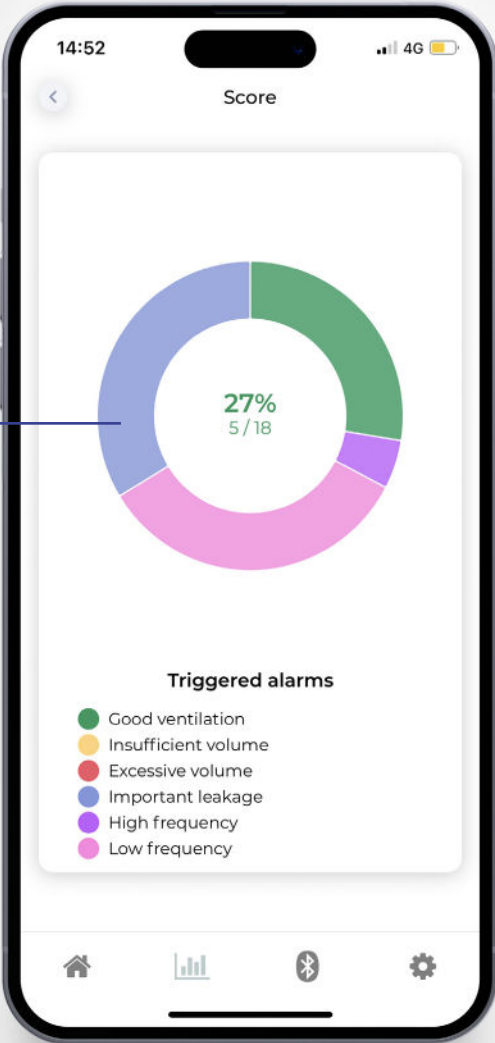

B

# 05.VENTILATION FREQUENCY

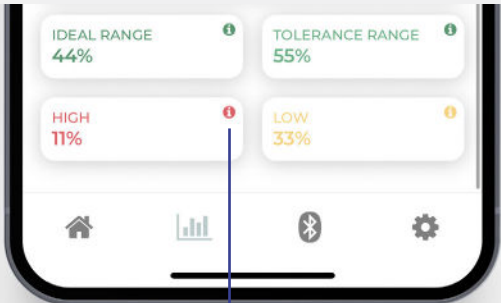
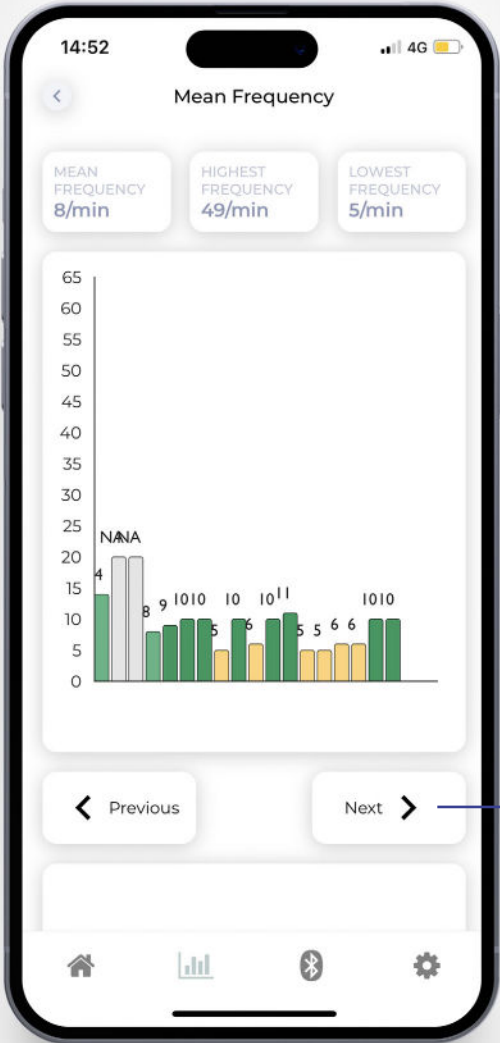

Press (i) to get more information about your results

Press on previous or next to navigate the graph

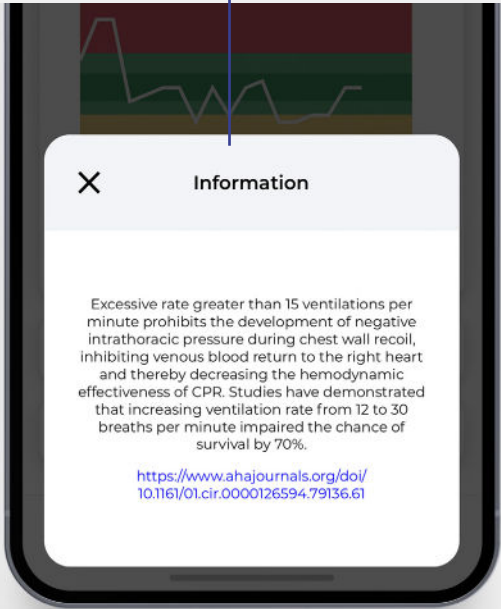

# 06.VOLUME DETAILS

B

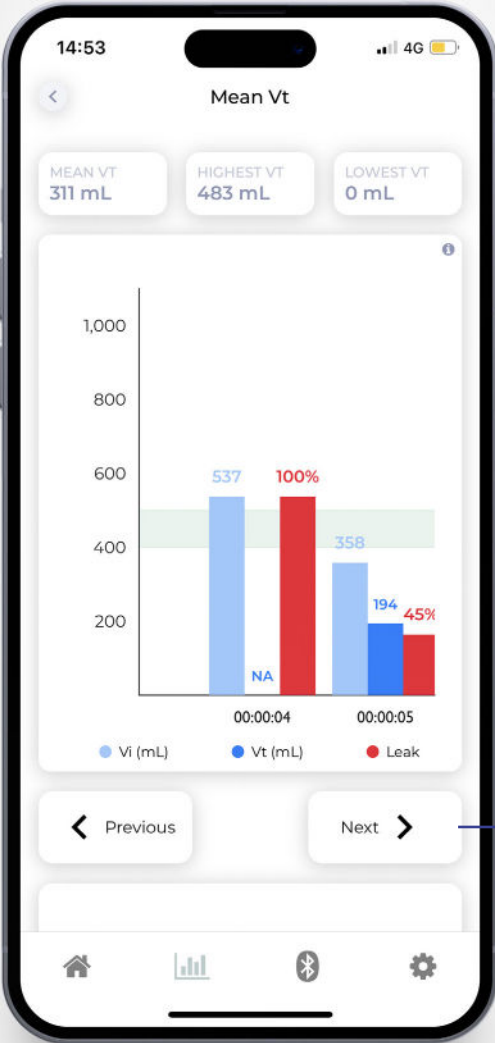

Press on previous or next to navigate the graph



# 01.SETTINGS

14:53 4G

Settings

- User management: Add, modify or delete users
- Legal: Privacy Policy, legal notice
- About us: Who is Archeon medical ?
- Support: Read the FAQ or contact us by email for any question
- EOLife X update: Update your EOLife X (only available on tablet)
- Save data: Backup all your recorded sessions on your mobile/ tablet (page 15)
- Restore database: Restore EOLife Connect database (page 16)

## 02.SAVE YOUR DATA

C

This feature can be used before changing your device.

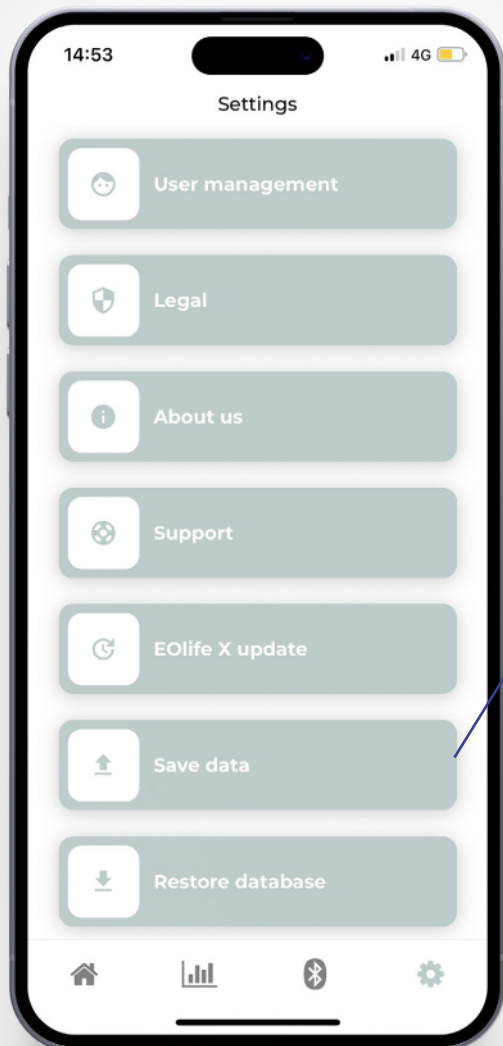

Press on 'Save data' and press on 'Yes'

Your entire EOLife Connect database will be saved onto your phone or tablet in a specific folder under the name:  
*eolife-connect-db-backup-{year}-{month}-{day}-{time}.json*

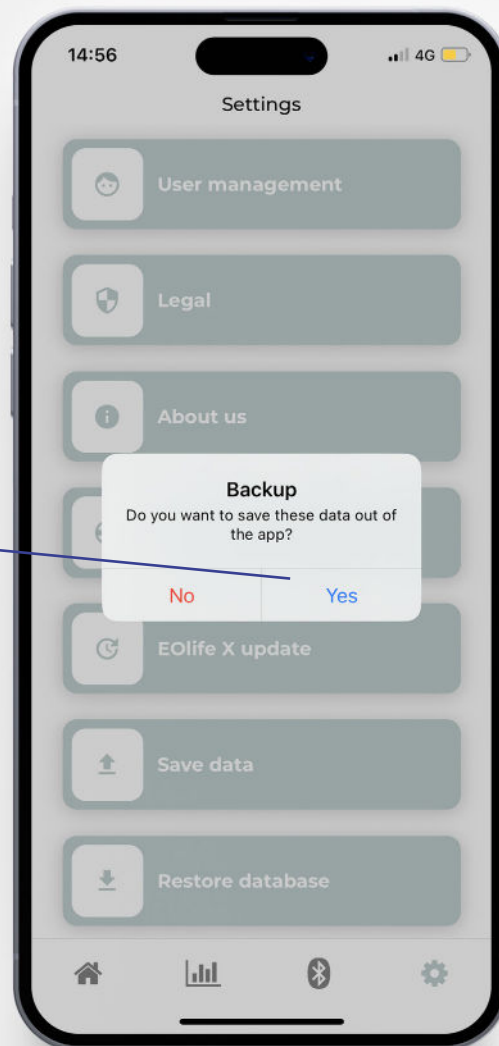

## C

## 03.RESTORE DATABASE

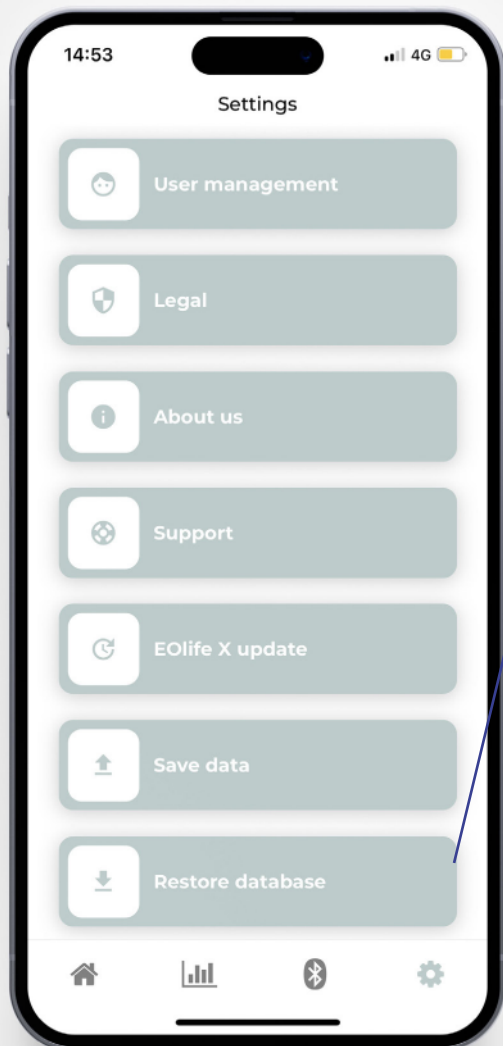

Press on 'Restore database' and press on 'Yes'.  
On your mobile/tablet select a 'json' file in your mobile/tablet.

**WARNING !**

Your EOLife Connect database will be overwritten by imported data. Make sure to perform a backup before restoring the database

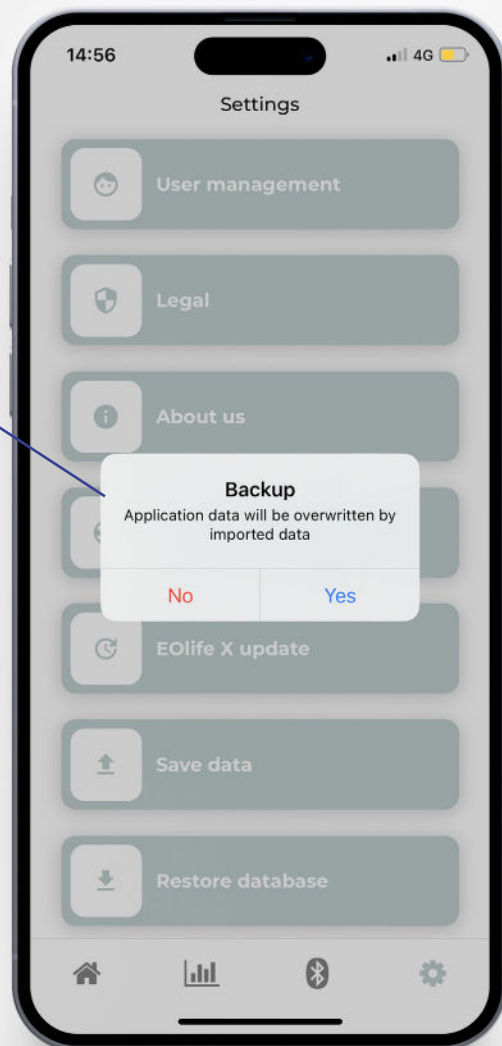





---

Copyright © 2023 Archeon Medical - All rights reserved  
Ver01 - November 2023

Archeon Medical - 2 chemin des aiguillettes - 25000 Besançon - FRANCE  
Tel +33 (0)3 81 66 23 80 - [www.archeon-medical.com](http://www.archeon-medical.com)